

Model:

- 51004 – 1/4", 15,000 RPM
- 51007 – 1/4", 20,000 RPM
- 51010 – 1/4", 18,000 RPM
- 51012 – 1/4", 24,000 RPM
- 51018 – 6mm, 15,000 RPM
- 51019 – 6mm, 18,000 RPM
- 51021 – 6mm, 20,000 RPM
- 51052 – 6mm, 24,000 RPM

# Standard Duty/ Direct Drive Die Grinder

**Air Motor and Machine Parts**



Always operate, inspect and maintain this tool in accordance with the Safety Code for portable air tools (ANSI B186.1) and any other applicable safety codes and regulations. Please refer to Dynabrade's Warning/Safety Operating Instructions for more complete safety information.

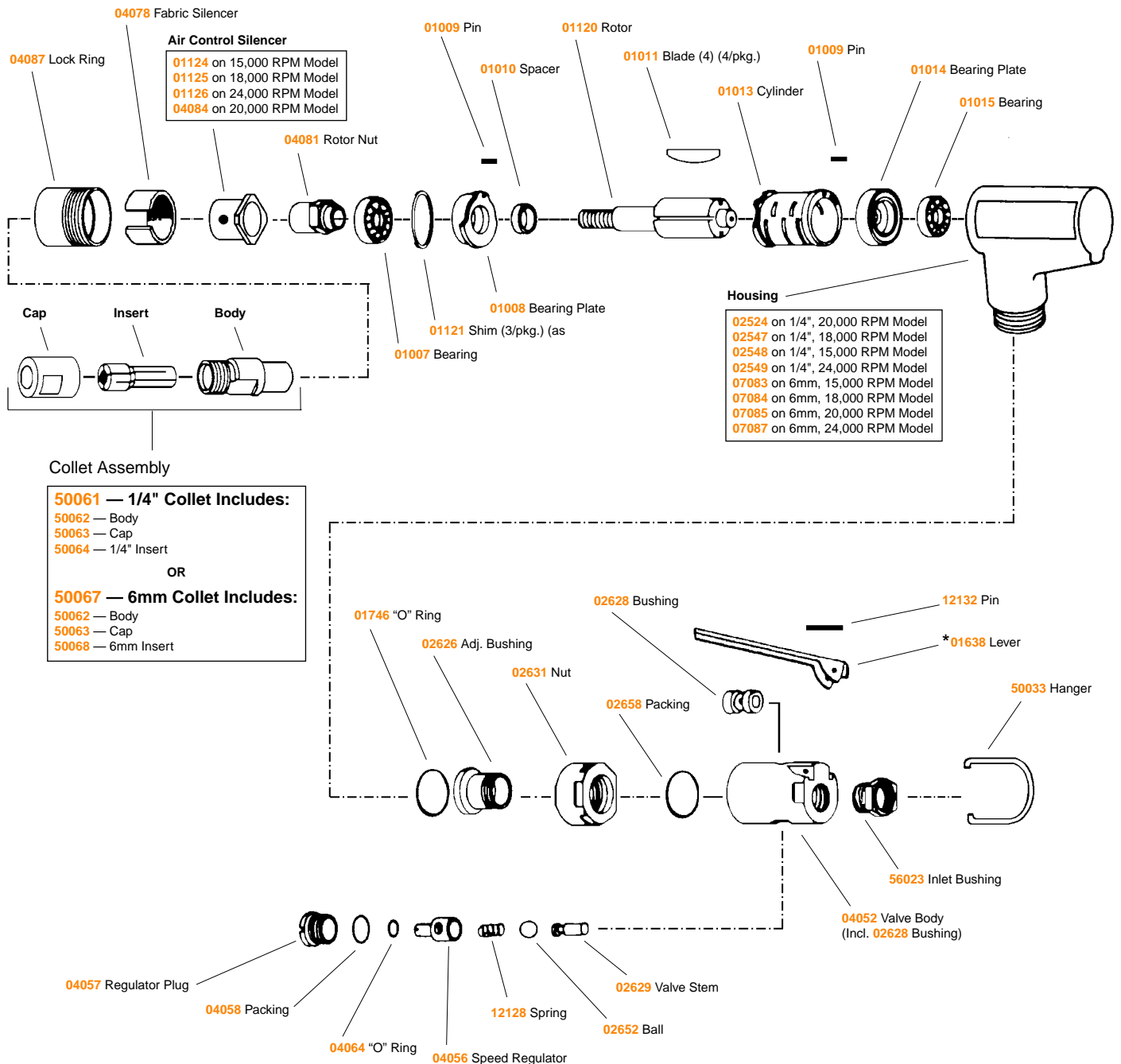

\*Safety lock lever assembly available.

See reverse side for accessories and important operating instructions.

## Optional Accessories

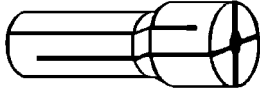

### Collet Inserts

- 50065 — 1/8"
- 50039 — 8mm

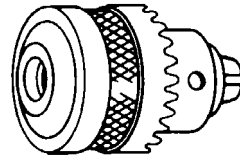

### 53032 — 1/4" Drill Chuck

Includes: 53052 Mated Chuck Key

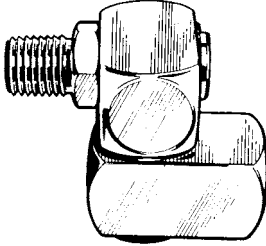

### Dynaswivel®

Swivels 360° at two locations which allows an air hose to drop straight to the floor, no matter how the tool is held.

- 95460 1/4" NPT

### 95603 — Motor Tune-Up Kit:

Includes assorted parts to help maintain motor in tip-top shape.

---

## Wrenches

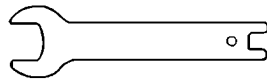

95281 — 19 mm open-end

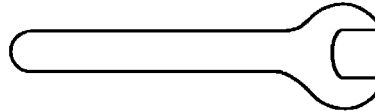

95262 — 14 mm open-end

---

**IMPORTANT:** ALL DYNABRADE AIR TOOLS MUST BE USED WITH A FILTER-REGULATOR-LUBRICATOR TO MAINTAIN ALL WARRANTIES

## IMPORTANT

- Tool RPM rating must never exceed abrasive/accessory RPM rating, regardless of the tool's capacity.
- Check tool speed regularly with a tachometer. If tool is operating at a higher speed than the RPM marked on the tool, the tool should be serviced to correct the cause before use.
- The air motor of this Dynabrade air tool should be lubricated with a minimum of 2 drops of Dynabrade Air-Lube (P/N — 95842) every 4 hours of use.
- For this air tool, Dynabrade recommends the use of their 11289 Air Line Filter-Regulator-Lubricator which provides two-stage filtration of water contaminants and micro-mist lubrication of pneumatic components; operates 28 CFM @ 90 PSI; has 3/8" female ports.

**Note:** To order replacement parts specify the model and serial number of your machine.

**Warning:** Hand, wrist and arm injury may result from repetitive work motion and overexposure to vibration.

